

MECHANICAL CASE OUTLINE
PACKAGE DIMENSIONS

ON Semiconductor®



DPAK / TP-FA
CASE 369AH
ISSUE 0

DATE 30 JAN 2012

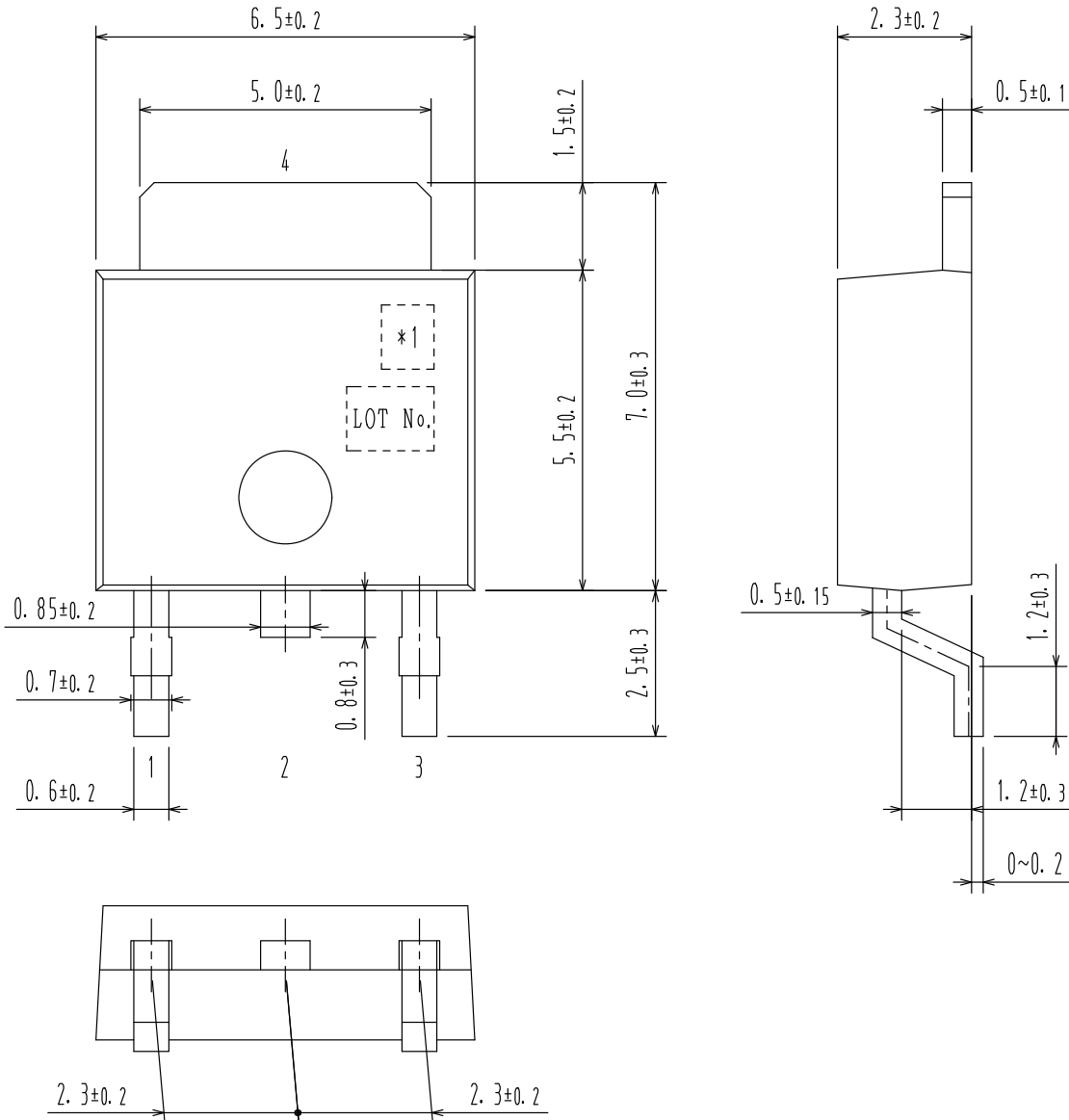

Pin 2 is idle pin with electrical designation only carried.

- 1:
- 2:
- 3:
- *1: Lot indication
- 4:

DOCUMENT NUMBER:	98AON66236E	Electronic versions are uncontrolled except when accessed directly from the Document Repository. Printed versions are uncontrolled except when stamped "CONTROLLED COPY" in red.
STATUS:	ON SEMICONDUCTOR STANDARD	
NEW STANDARD:		
DESCRIPTION:	DPAK / TP-FA	PAGE 1 OF 2

